

LED Motion Sensing

LT-MS-A

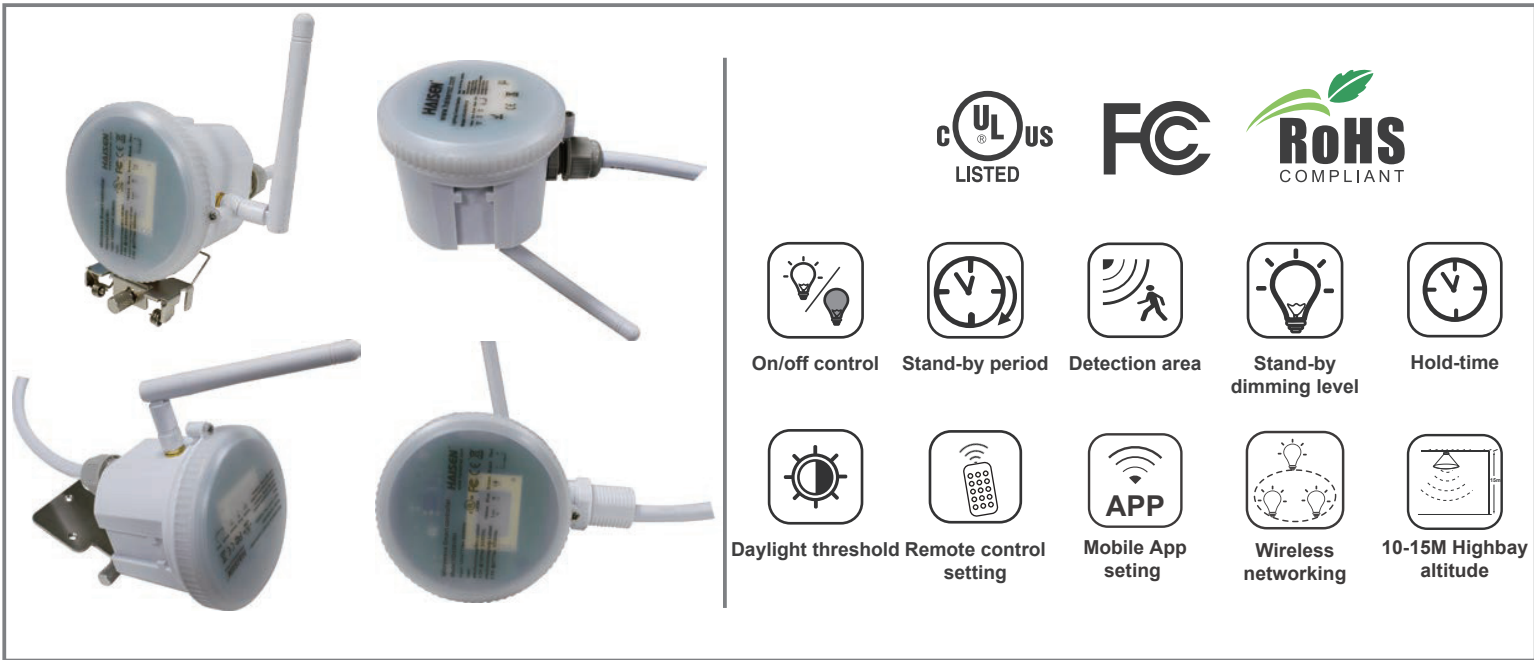

Specifications

Operating voltage	120-277VAC,50Hz/60Hz
Switching capacity	Max,3.0A@120Vac,50/60Hz Max,2.0A@277Vac,50/60Hz
Standby power	≤0.5W
Detection area	25%/50%/75%/100%
Hold-time	5s/30s/1min/3min/5min/10min/20min/30min
Daylight threshold	2Lux/10Lux/30Lux/50Lux 80Lux/120Lux/Disable
Stand-by period	0s/10s/30s/1min/5min/10min/30min/+∞
Stand-by dimming level	10%/20%/30%/50%
Microwave frequency	5.8GHz±75MHz
Microwave power	<1mW
Mounting height	Max.15m
Detection range	Max.(D x H): 16m x 15m
Operating temperature	-35°C~+60°C
IP rating	IP65
Detection angle	150° (wall installation) 360°(ceiling installation)
Safety standard	EN61347-1 EN61347-2-13 EN60598-1
Control line	Brown L,Blue N,Yellow L',Black -,Red +

LED Motion Sensing

LT-MS-A

Installation Method

Unit : mm

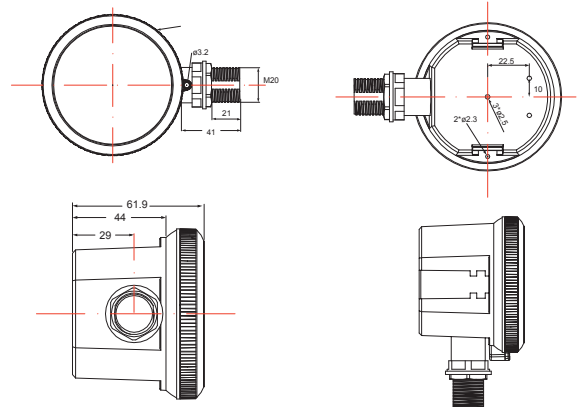
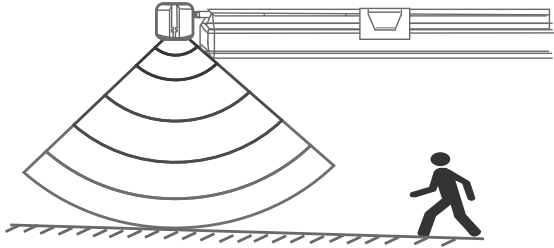

Detection coverage

Ceiling Mounted

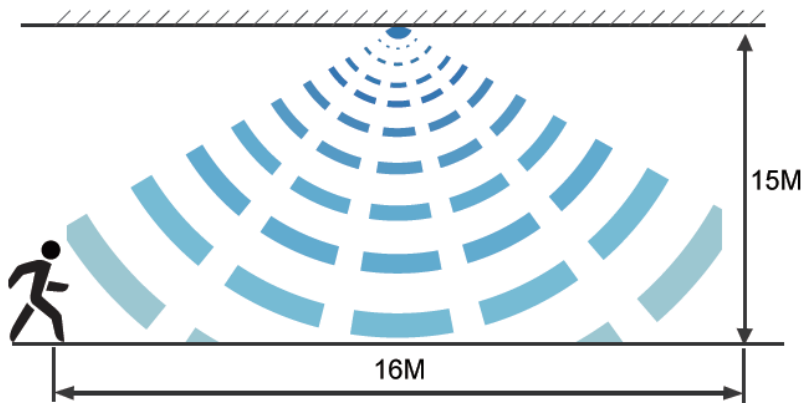

Wall Mounted

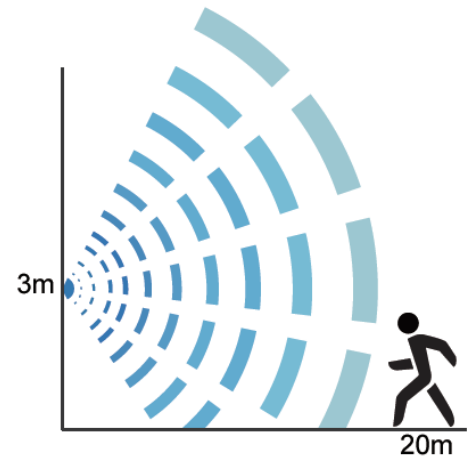

Application

Function Demo - Dimmable control/Corridor function

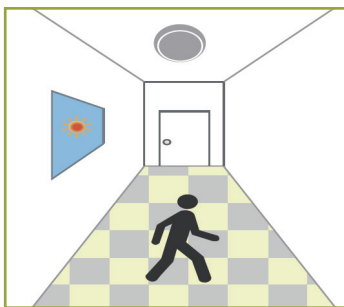

When motion detected, but sufficient daylight, light remains OFF.



When motion detected, insufficient daylight, light ON.

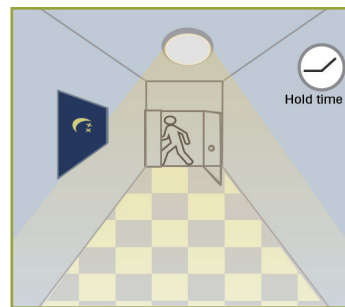

After last detection, the light will be dimmed down to the stand-by dimming level(10%,20%30%,50%).

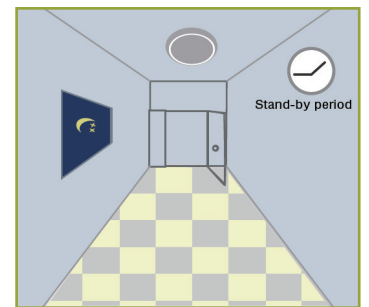

After the stand-by period, light OFF.

Note: Motion sensor setting and dimming setting please refer to remote control Standard remote control.

LT-MS-A

Standard remote control

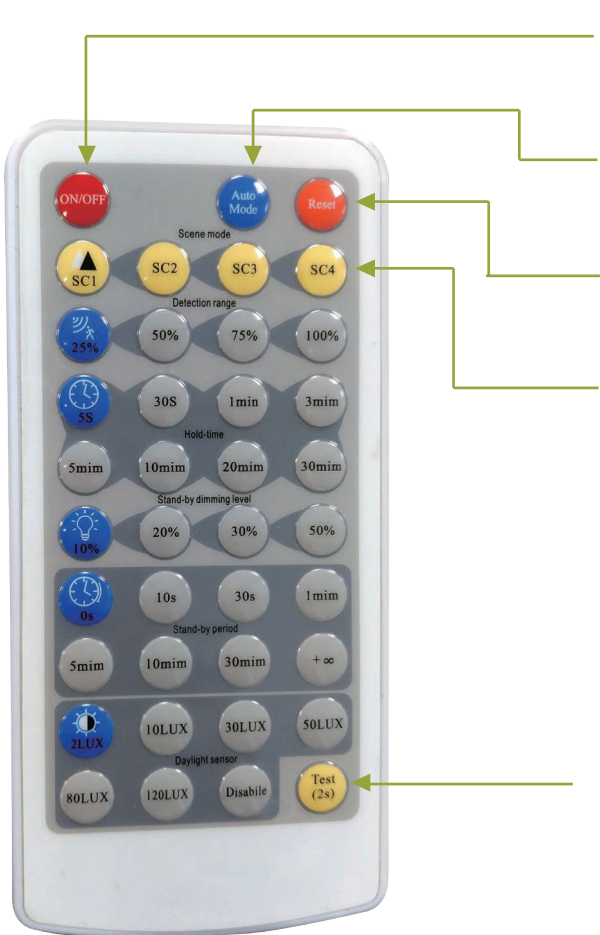

ON/OFF

Press the "ON/OFF" button, the light keeps permanently on or off.
* Press "Auto Mode", "RESET" or "Scene mode" buttons to quit from this mode.

Auto Mode

Press "Auto Mode" button, the sensor starts to work and all settings remain the same before the light gets switched on/off.

Reset

Press "RESET" button, products with DIP switch will be controlled by DIP switches;

▲ Auto Mode

Scene mode	Detection area	Hold-time	Daylight threshold	Stand-by period	Stand-by dimming level
SC1	100%	30s	2Lux	1min	10%
SC2	100%	5min	10Lux	10min	10%
SC3	100%	10min	50Lux	30min	10%
SC4	100%	30min	Disable	+ ∞	10%

Test (2s)

The button "Test (2s)" is for testing purpose after commissioning. Pressing this button, the sensor goes to test mode (hold time is only 2s) automatically, stand-by period and daylight sensor are disabled. This mode can be ended by pressing "reset", "Auto mode", "scene mode" or "hold time". The sensor setting is changed accordingly. Brightness settings: Disable
Test mode can press any key to exit this mode.



On/off control

There are 4 fixed scene modes program built-in the remote control to choose for different applications.



Detection area

Press the button "detection range" to set detection range as 100% / 75% / 50% / 10%.



Hold-time

Press the button "hold-time" to set hold-time as 5s / 30s / 1min / 3min / 5min / 10min / 20min / 30min .



Daylight sensor

Press the button "daylight sensor" to set daylight threshold as 2Lux / 10Lux / 30Lux / 50Lux/ 80Lux/ 120Lux/ disable.



Stand-by period

Press the button "stand-by period" to set stand-by period as 0s / 10s / 30s / 1min / 5min / 10min / 30min / + ∞
Note: "0s" means on/off control; "+ ∞" means bi-level dimming control.



Stand-by dimming level

Press the button "stand-by dimming level" to set the stand-by dimming level as 10% / 20% / 30% / 50%.

Sensor installation method

The distance between the inductor and the sensor is 4m wide;
Recommended installation of sensor suction ceiling height 3-6m;
Wall mounting height suggested 1-1.8m;
The remote controls the most remote distance 15 meters (in different places remote control distance will have the deviation)
Weight (including battery): 56.5g

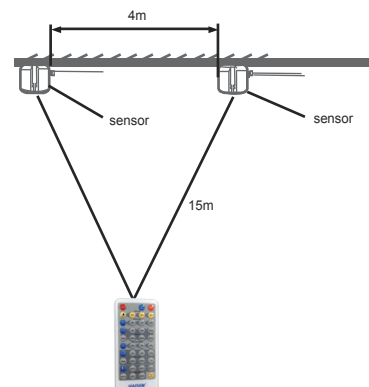

The instruction of Haisenlight APP for LT-MS-A



1. Download

- (1) Android phone user can download the APP from Google Play market by searching Haisen.
- (2) Or scan below QR to download from Baidu network .
- (3) iPhone user can search Haisen in APP store and download it.



2. Registration with phone number or email

3. Bluetooth should always be on while use the APP

1. APP homepage

4 main manu

Room: control and manage devices

Scene: Create a scene to control devices on or off

Device: control single device or groups

User: Sign in, sign out, share or receive control ability

2. Device plug-in

1. Into the Device screen.
2. Press "+" on the top right corner, select "add new device" to start searching.
3. Press "+" to add the shown device
4. Rename the device by long pressing or sliding to left (IOS user).
5. Click the device to manage it.
6. Auto add: Automatically add powered on devices; added devices will flick until exit "Auto add".

3. Grouping

1. Into the Device page
2. Press "+" on the top right corner, select "add new group"
3. (1) Group name can be changed.
(2) In the list are connected devices
(3) Press "+" to add not-connected devicesp.
(4) Press "added" to delete added devices.
(5) Non-connected devices can't be added to or deleted from the group.
(6) Press the top right corner to save
4. Rename or delete the group by long pressing it or sliding to left (IOS user); Delete inner devices before delete the group
5. Click the group to control it.
6. SYNC: one device works, other devices in the same group will work too.

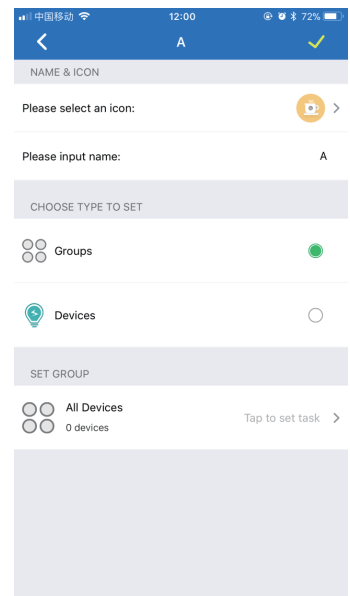

(Figure 1)

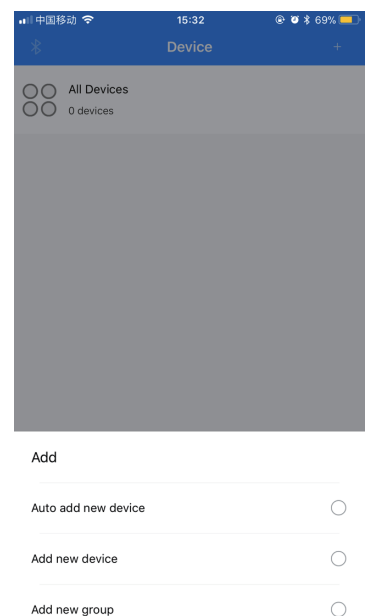

(Figure 2)

4. ROOM

Build different rooms to control and manage in-room devices

1. Choose a room picture or press "+" to build a room.
2. Edit the room:
 - (1) Change the room picture.
 - (2) Change the room name.
 - (3) add or delete or group device.
 - (4) Save or delete the room on the top right corner.
 - (3) Press the top left corner to exit room.
3. Select the room picture to directly control devices in the room

5. SCENE

To control devices always on or always off

1. Press "+" on the top right corner to create a scene.
 - (1) Choose an icon.
 - (2) Input a name
 - (3) Choose to control group or device always on or off.
 - (4) Press the top right corner to save the setting.
2. Long press the scene or slide to left (IOS user) to edit or delete the scene.

6. DEVICE

Control single device or groups or rooms

1. Setting display.
2. Brightness changing bar and switch.
3. STEST or Reset button to exit the ON/OFF mode.
4. Reset button changes settings to "Detection range 100%, holdtime 5S, no standby, daylight disabled".
5. Test button changes settings to test mode: Detection range 100%, holdtime 2S, no standby, daylight disabled.
6. Brightness 80% as the max brightness in changing setting, Reset to make it 100%.
7. Change all the setting, press SAVE on the top right corner to save it as new scene or update the existing scenes.(Only 4 new scenes are allowed).

7. Others

1. Share the lighting control
 - (1) Into the USER page, press SHARE NET
 - (2) Let the receiver to scan the QR code
 2. Get the lighting control
 - (1) Into the USER page, press GET NET, scan the sharer 's QR code
 - (2) Choose the correct one from CURRENT NET
 - (3) Receiver only has the power to manage, not change
 - (4) Choose other net from CURRENT NET to exit
 3. Failed bluetooth connection
Usually happened on Android phone (automatically cookie clean), the user just reconnect tthe bluetooth.
 4. Delete device
 - (1) Long press the device name on Device page or slide to left (IOS user)
 - (2) Force delete: can be used to delete devices when mobile APP and device are disconnected
- Force reset:
1. Needed when connected devices can't be deleted (such as the first mobile isn't available and second phone needs to connect devices)
 2. (1) Force reset operation: Keep devices on for 2 seconds, turn off and keep 5 seconds, then turn on and keep 2 seconds, repeat 5 times
 - (2) Devices are available after force reset.

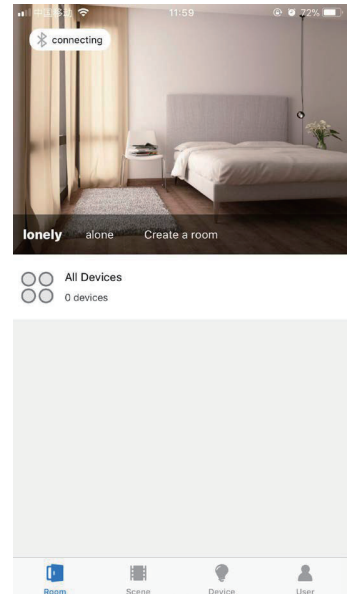

(Figure 3)



(Figure 4)



(Figure 5)