

IP65 High altitude installation remote control Settings HD406VRH

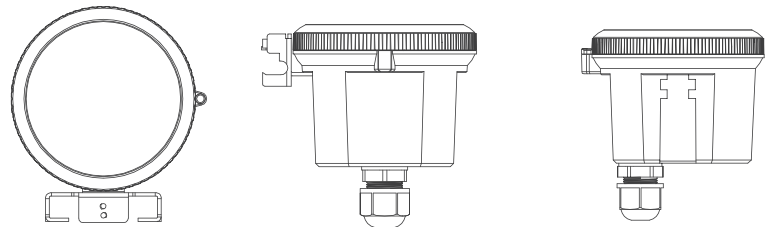

On/off control



Stand-by period



Detection area



Stand-by
dimming level



Hold-time



Remote control
setting



Daylight threshold

01 Technical data

Operating voltage	120-277VDC,50Hz/60Hz
Switching capacity	800W@120-220Vac,1000W@220-277Vac(Incandescent lamp); 400W@120-220Vac,800W@220-277Vac(Control gear)
Standby power	<1W
Detection area	25%/50%/75%/100%
Hold-time	5s/30s/1min/3min/5min/10min/20min/30min
Daylight threshold	2Lux/10Lux/30Lux/50Lux 80Lux/120Lux/Disable
Stand-by period	0s/10s/30s/1min/5min/10min/30min/ + ∞
Stand-by dimming level	10%/20%/30%/50%
Microwave frequency	5.8GHz±75MHz
Microwave power	<1mW
Mounting height	Max.15m
Detection range	Max.(D x H): 16m x 15m
Operating temperature	-35°C~ +70°C
IP rating	IP65
Detection angle	150° (wall installation) , 360° (ceiling installation)
Safety standard	EN61347-1 EN61347-2-13 EN60598-1
Size	ø80x61.9mm
Certificate	cULus listed,FCC

02 Wiring diagram

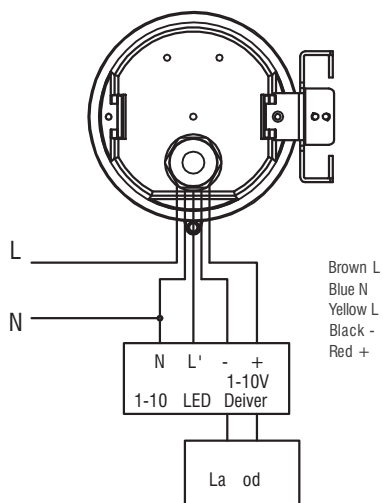

03 Mechanical structure(mm)

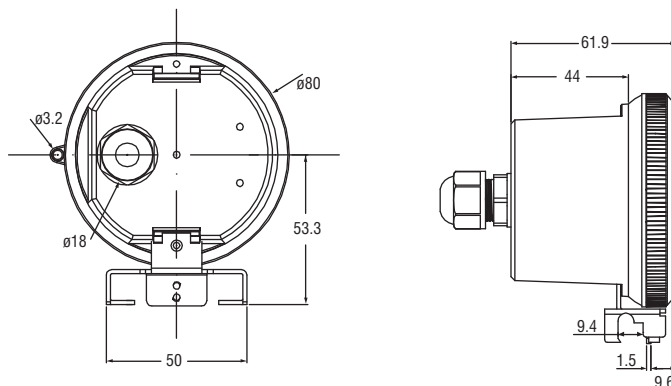

04 Installation Method

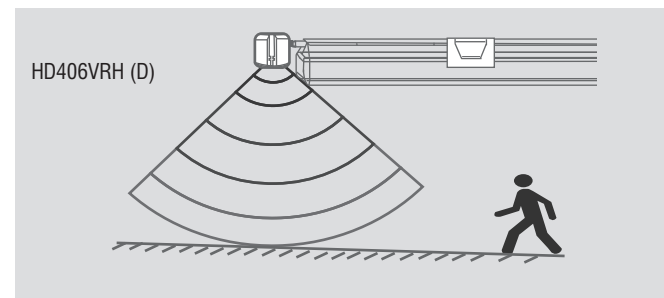
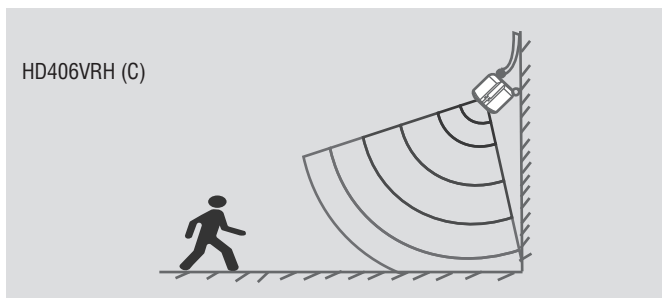
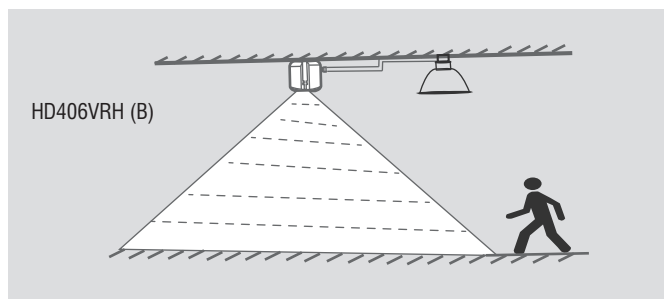
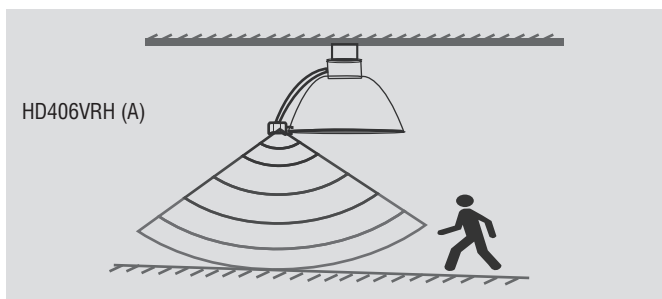

05 Application Function Demo - Dimmable control/Corridor function

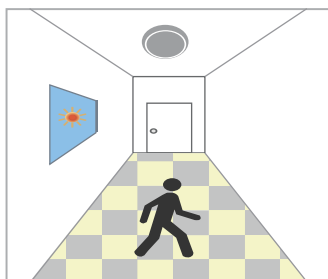

When motion detected, but sufficient daylight, light remains OFF.



When motion detected, insufficient daylight, light ON.

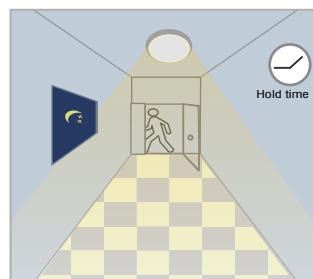

After last detection, the light will be dimmed down to the stand-by dimming level (10%, 20%, 30%, 50%).

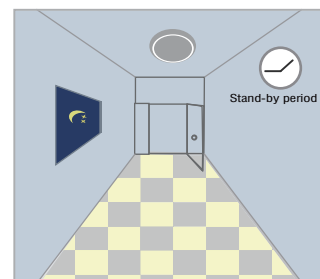

After the stand-by period, light OFF.

Note: Motion sensor setting and dimming setting please refer to remote control HD02R.